

THE RESOURCES AGENCY OF CALIFORNIA
 CALIFORNIA DEPARTMENT OF FISH AND GAME
STREAM SURVEY

FILE FORM NO:..... DATE:.....

NAME.....Low Gap Creek.....**COUNTY**.....Mendocino.....
STREAM SECTION....Entire..... **FROM**....Mouth..... **TO**....Log Bar Up from Mouth..... **LENGTH**....1.3 mi...
TRIBUTARY TO.....South Branch North Fork Navarro River..... **TWP**...15N... **R**...14W... **SEC**....23.....
OTHER NAMES.....None..... **RIVER SYSTEM**.....Navarro.....
SOURCES OF DATA.....observation and information from Masonite Corp., Ukiah, California foresters.....

EXTENT OF OBSERVATION Include: Name of Surveyor, Date, Etc.
LOCATION
RELATION TO OTHER WATERS
GENERAL DESCRIPTION
Watershed
Immediate Drainage Basin
Altitude (Range)
Gradient
Width
Depth
Flow (Range)
Velocity
Bottom
Spawning Areas
Pools
Shelter
Barriers
Diversions
Temperatures
Food
Aquatic Plants
Winter Conditions
Pollution
Springs
FISHES PRESENT AND SUCCESS
OTHER VERTEBRATES
FISHING INTENSITY
OTHER RECREATIONAL USE
ACCESSIBILITY
OWNERSHIP POSTED OR OPEN
IMPROVEMENTS
PAST STOCKING
GENERAL ESTIMATE
RECOMMENDED MANAGEMENT
SKETCH MAP
REFERENCES AND MAPS

EXTENT OF OBSERVATION - The entire stream was checked by foot by John Rowell and Bob Keller on July 14, 1962.

LOCATION - Low Gap Creek is approximately 16 miles west of Ukiah.

RELATION TO OTHER WATERS - This is a headwater tributary to the Navarro River containing some steelhead and/or rainbow; trout spawning and nursery areas.

GENERAL DESCRIPTION

Watershed and Immediate Drainage Basin - Low Gap Creek lies within the coastal redwood area flowing through a V-shaped canyon. It flows southward through uncultivated land, draining approximately 35 sq. miles. Side slopes contain redwood, fir, bay, madrone and some alders. A few patches of grassland are also present. The trees along the stream edge provide adequate shade.

Altitude - Low Gap Creek rises at 1600 ft. above sea level, dropping to 960 ft. above sea level at the mouth.

Gradient - Steep in the headwaters region, dropping 400 ft./1000 ft. from Soda Creek downstream, gradient is almost flat, dropping approx. 25 ft./1,000 ft.

Width - Ranged between 2' and 4" throughout the entire stream section, averaging 3 inches.

Depth - A 3-inch depth was fairly consistent throughout.

Flow - Above the mouth or Soda Creek, flow was less than 1/2 cfs.

From Soda Creek downstream, the float method of measuring showed 1 cfs to be flowing.

Velocity - Slow throughout.

Bottom - From Soda Creek upstream the bottom was mostly gravel-mud mixture. From Soda Creek to the mouth, the bottom was composed of 45% rubble, 45% gravel, and 10% sand.

Spawning Areas - From Soda Creek downstream to the mouth 70% of the bottom had good steelhead and/or rainbow trout spawning gravel.

Pools - Most of the pools were oval in shape, depth throughout ranged between 6" and 12".

Frequency was poor. All pools were under 12' in length. Pools 20% and riffles 80%.

Shelter - Overhanging brush and boulders gave the fish present adequate shelter.

Barriers - None -observed. See barrier survey map for location of log jams.

Diversions - None observed.

Temperatures - Temperatures were taken between 1300 and 1500 on a clear day.

The air temperature was 80° F., water 60° F.

Food - Caddis fly and other dipterous insects appear to be adequate.

Aquatic Plants -Horsetail and algae were present in small amounts.

Winter Conditions - High water mark and debris on the bank indicate winter conditions are rather mild this far upstream.

Pollution - None observed.

Springs - None observed.

FISHES PRESENT AND SUCCESS - Steelhead and/or rainbow trout and the 2¹ to 5" range were the only fishes observed. Their condition appeared to be good. They averaged 30 to 40 fish/100 ft. of stream. Natural propagation is good. The upper fisheries limit is 1/10 mile above the junction with Soda Creek.

OTHER VERTEBRATES - Frogs, snakes, deer and some cattle were present.

FISHING INTENSITY - None known.

OTHER RECREATIONAL USES - Deer hunting is possibly the only other recreation in this area.

ACCESSIBILITY - The headwaters are reached via either Low Gap Road or Masonite Road. If via Masonite Road, turnoff at mile post '6.5. The mouth is reached via Masonite Road, turning or. to Rose Creek Road at mile 20.9. Travel time from Ukiah to the headwaters 45 minutes; to the mouth, 1 hour.

OWNERSHIP - Masonite. Corp., Ukiah, California

POSTED OR OPEN - Posted by Masonite. Corp., Ukiah, California.

IMPROVEMENTS - Removal of logging debris from the lower 1.2 miles will improve-the habitat for steelhead and/or rainbow trout.

PAST STOCKING - None known.

GENERAL ESTIMATE - Low Gap Creek, a V-shaped canyon within the coastal redwood belt has been partially logged. The few log jams present are not barriers. Summer flows which come from Soda Creek; are plentiful for fishlife in the usable portions of Low Gap Creek. Good spawning gravel is present throughout. Steelhead, and/or rainbow trout seemed to be quite plentiful.

RECOMMENDED MANAGEMENT - Low Gap Creek should be managed as a steelhead and/or rainbow trout spawning and nursery area.

SKETCH MAP - See attached map.

REFERENCES AND MAPS - Three maps were used for reference:

#1. U.S. Dept, of Interior, Geological survey, 7 1/2 minute series topographic map, Booneville quads, advanced sheet, 1962.

#2. Masonite Corp., Ukiah, California property and topographic map based on. U.S. Department Maps, 1943.

#3. U.S. Department of Interior geological survey 15-minute series topographic map Booneville quads, 1959.

Low Gap Creek

T. 15N

R. 14W

Sec. 23

$\frac{10}{18174}$

$\frac{11}{19175}$

Spawning and Nursery Area in miles

- 1. Now satisfactory for SH & SS .1
- 2. To be improved .6
- 3. Available after improvement .7

Surveyor Rowell & Keller

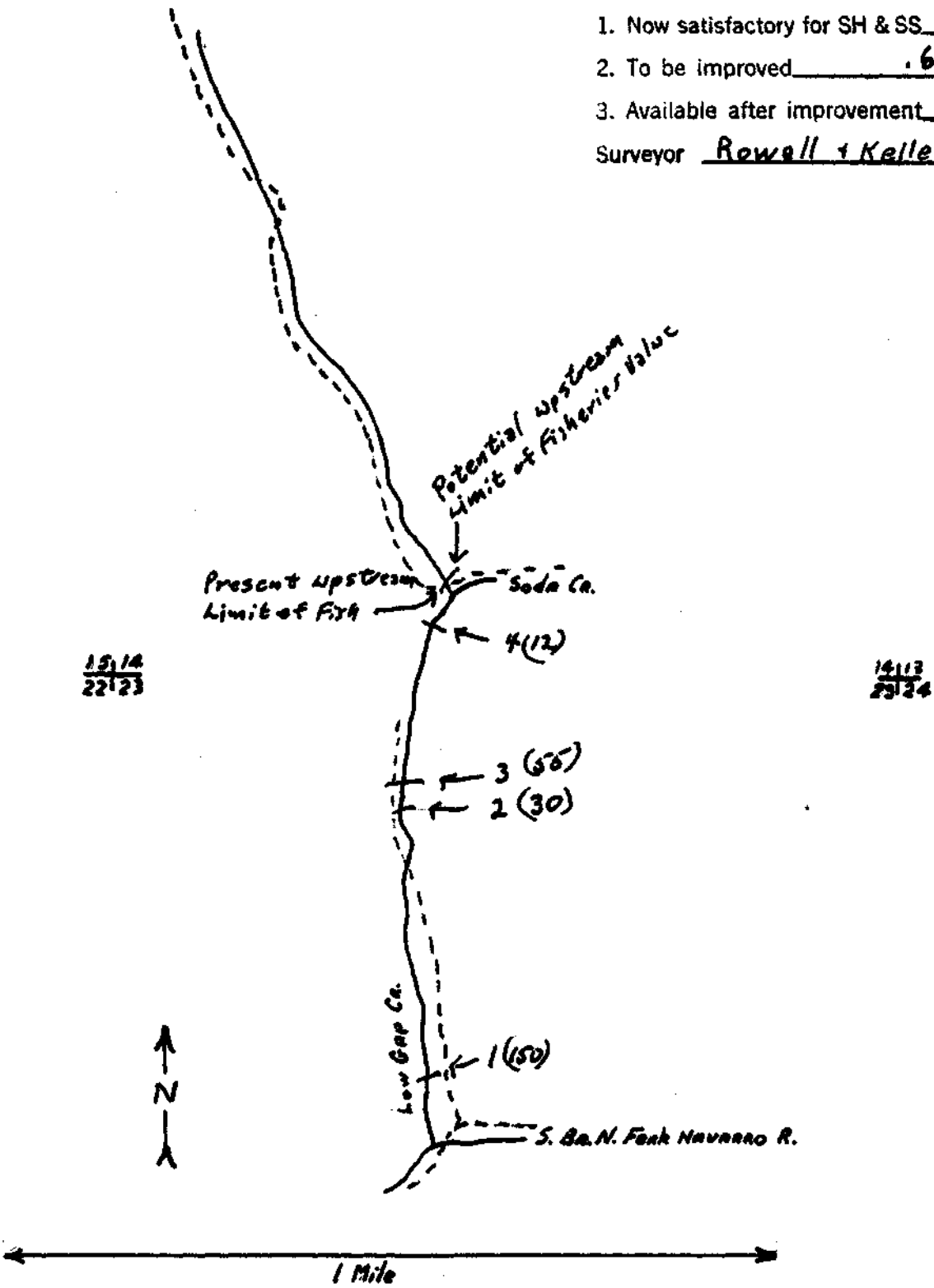

Add 5% between Numbered Log Jams - for debris -