

CALIFORNIA DEPARTMENT OF FISH AND GAME
STREAM SURVEY

NAME....SHINGLE MILL CREEK.....COUNTY.....Mendocino.....
 STREAM SECTION...Entire... FROM...Headwaters.....TO....Junction Navarro River...LENGTH..1.5..mi....
 TRIBUTARY TO....South Branch Navarro River.....Twp...15N...R...14W...Sec..17.....
 OTHER NAMES.....None known.....RIVER SYSTEM...Navarro River.....
 SOURCES OF DATA.....Personal survey.....

EXTENT OF OBSERVATION
Include Name of Surveyor, Date, Etc.
LOCATION
RELATION TO OTHER WATERS
GENERAL DESCRIPTION
Watershed
Immediate Drainage
Basin
Altitude (Range)
Gradient
Width
Depth
Flow (Range)
Velocity
Bottom
Spawning Area
Pools
Shelter
Barriers
Diversions
Temperature
Food
Aquatic Plants
Winter Conditions
Pollution
Springs
FISHES PRESENT AND SUCCESS
OTHER VERTEBRATES _
FISHING INTENSITY
OTHER RECREATIONAL USE
ACCESSIBILITY
OWNERSHIP
POSTED OR OPEN
IMPROVEMENTS
PAST STOCKING
GENERAL ESTIMATE
RECOMMENDED MANAGEMENT
SKETCH MAP
REFERENCES AND MAPS

EXTENT OF OBSERVATION - Walked out from the headwaters confluence of the South Branch Navarro River a distance of 1.5 miles on July 23, 1962 by H. Adams and B. Keller.
 LOCATION - Arises 21 miles west of Ukiah via Masonite Road to Rose Creek Road B. Stream crossed by Rose Creek Road .4 mile south of Masonite industrial road.
 RELATION TO OTHER WATERS - This is one of the main small tributaries to the South Branch of the Navarro River. It is a good spawning and nursery stream.
 GENERAL DESCRIPTION - Watershed & Immediate Drainage Basin - Steep, V-shaped canyon walls with a sandy soil consisting of predominantly second growth redwood with some fir. This drainage is approximately 4 sq. miles.
Altitude - The altitude of 785 ft. headwaters to 650 ft. at the junction with the South Branch of Navarro River, with a range of 115 ft.
Gradient - Moderate throughout the stream section with 115 ft. drop in 1.5 miles of stream.
Depth - An average of 3 in. with a range of 2" to 5".
Width - Average of 4 ft. with a range of 2' to 6'.
Flow - 1/4 cfs throughout estimated taken by the float method.
Velocity - Slow throughout.
Spawning Area - 90% of stream has good spawning gravel located in the lower 1.3 miles of stream. The remaining

10% is silt located in the upper .2 mile of stream.
Pools - 60% is pool caused by jams and debris with a range of 1' to 5' wide, 3' to 6' long, 6" to 24" deep with an average of 3' wide, 6' long and 18" deep.
Shelter - Good to excellent shelter throughout entire section surveyed consisting of jams and debris with some undercut banks.
Barriers - Two possible barriers were observed. One is located 1.2 miles upstream from the junction of the South Branch of the Navarro River. A 3' falls consisting of logs silted in behind. The second .2 mile of stream from the junction of the South Branch of Navarro River consisting of 12' falls, and logs silted in behind.
Diversions - None observed.
Temperatures - Water 56° F., Air 69 F., taken at 11 a.m. on July 23, 1962, 1.5 miles from the junction of the South Branch of Navarro River.
Food - An abundance of mayfly and caddis fly larvae were observed.
Aquatic Plants - Horsetail and razor grass.
Winter Conditions - Moderate throughout.
Pollution - None observed.
Springs - None observed.

SHINGLE MILL CREEK
P-2 Mendocino County

FISHES PRESENT AND SUCCESS - Steelhead and/or rainbow trout were present with an average of 3" range from 2" to 4", 10 to 15 per 100 ft. of stream. Few fish were observed on riffle areas. Most of the fish were observed in the pool areas, contributing more shade and shelter.

OTHER VERTEBRATES - Frogs and deer were noted.

FISHING INTENSITY - None observed.

OTHER RECREATIONAL USE - Possibly deer hunting.

ACCESSIBILITY - Accessible via Masonite industrial road 21 miles west of Masonite plant in Ukiah to Rose Creek road B. Rose Creek road crosses Shingle Mill Creek at mouth .4 mile south of Masonite Road, an estimated one hour driving time from Masonite plant in Ukiah.

OWNERSHIP - Owned by Masonite Corp.

POSTED OR OPEN - Posted by Masonite Corp.

IMPROVEMENTS - None noted.

PAST STOCKING - None known.

GENERAL ESTIMATE - This stream has good potential as a steelhead and/or rainbow trout spawning and nursery stream. This stream is found in the typical redwood-Douglas fir transition type area. These second growth redwoods form good cover throughout the drainage. This stream has received no angling pressure due to the stream being posted to fishing. This stream also has many log jams and two potential barriers. The jams were caused by logging in the past ten years.

RECOMMENDED MANAGEMENT - This stream should be managed for steelhead and/or rainbow trout nursery and spawning area. The log jams and barriers should be removed to provide better spawning and nursery accessibility.

SKETCH MAP - See attached.

REFERENCES AND MAPS - U.S. Dept. of Interior Boonville quadrangle 15-minute series topographic printed in 1943.

Herbert Adams Seasonal Aid/cd 9-21-62

SHINGLE MILL CREEK

T. 15 N. R. 14 W. SEC. 17

8/9

Spawning and Nursery Area in miles

1. Now satisfactory for SH. & SS 0
2. To be improved 2 miles
3. Available after improvement 2 miles

Surveyor H. Adams

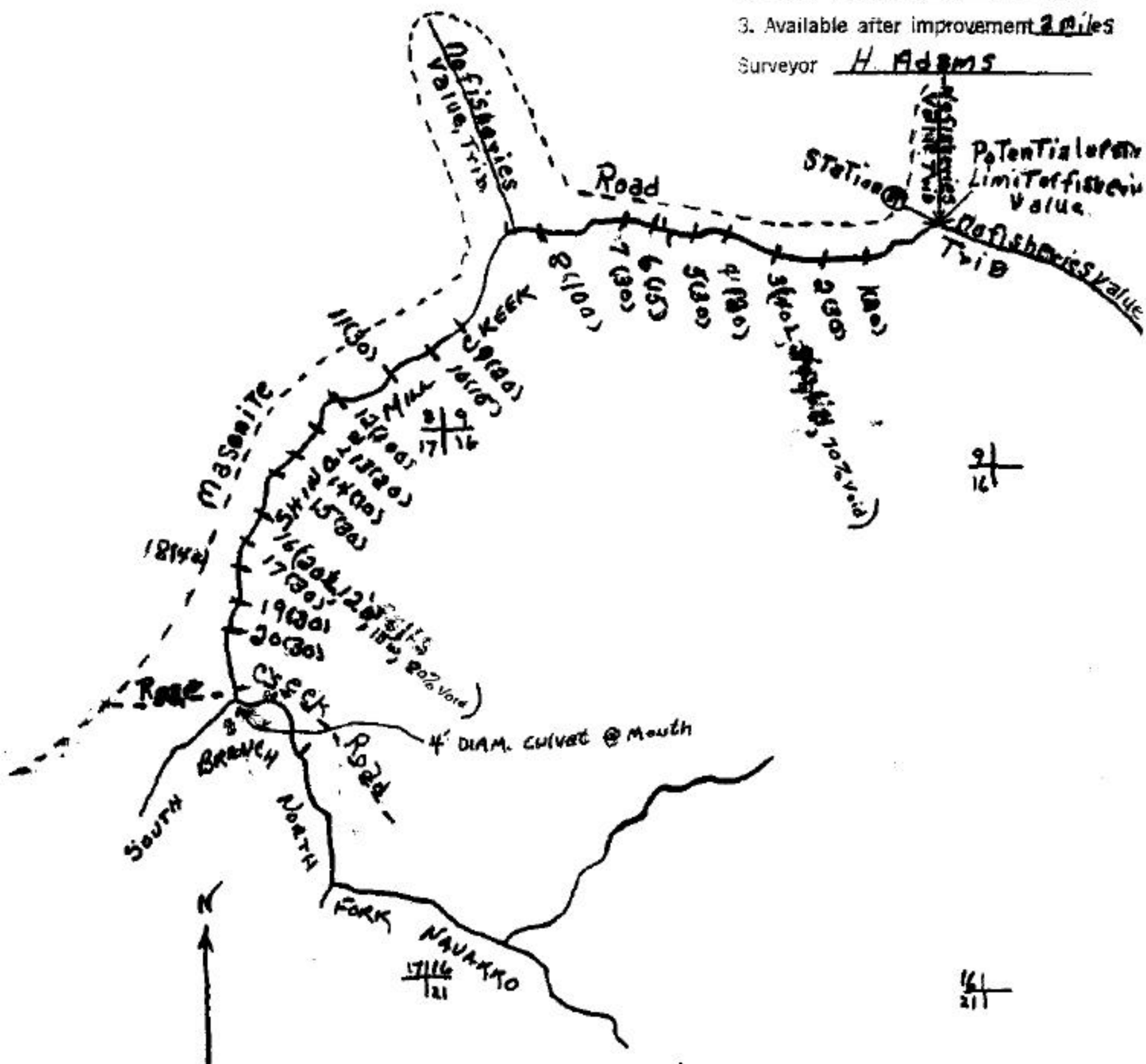

9/16

16/21

1 Mi.

Add 10% for debris not listed between jams